



NOTICE TO ALL BIDDERS

ADDENDUM NO. 2 TO TUCSON AIRPORT AUTHORITY TUCSON INTERNATIONAL AIRPORT

10119102 AIRFIELD SAFETY ENHANCEMENT (ASE) PROGRAM DESIGN BID BUILD 2 SERVICES

April 1, 2026

In accordance with the Bid Documents, Bidders on the above-referenced project are hereby notified that the following Addendum, dated April 1, 2026 shall be made a part of the Bid Documents. The Bidder shall acknowledge receipt of this addendum on the Bid Form.

GENERAL

1. Revised Plan Sheets
2. Revised Specification 26 05 01
3. Updated Bid Schedule

PROJECT SPECIFICATIONS AND CONTRACT DOCUMENTS

1. Section 26 05 01 Common Electrical Requirements – Updated Method of Measurement and Basis of Payment sections.

PROJECT PLANS

The following changes / corrections to listed plan sheets shall be made a part of the Contract Documents:

1. Sheet GI0.002 Index of Sheets & Summary of Quantities – Updated Summary of Quantities
2. Sheet EP1.001 Electrical Installation Plan I – Updated light pole callouts
3. Sheet EP1.002 Electrical Installation Plan II – Updated light and camera pole callouts
4. Sheet EP1.003 Electrical Installation Plan III – Updated camera pole callouts
5. Sheet EP1.003 Electrical Installation Plan III – Updated camera pole callouts
6. Sheet EP5.001 Camera Pole Base Detail – Updated Note 9
7. Sheet EP5.003 Lighting Pole Base Details – Updated pole height dimensions

RESPONSES TO QUESTIONS

Question 1: Note 10 states “conduit sizes as indicated on site planes”. Please clarify size conduit from ground “j” box to camera pole. Match the same size conduit as the future power conduit which is “1-inch”?

Answer: 2-inch as shown on sheets EP1.001 through EP1.004.

Question 2: Note 9 states “25’ square pole match existing”. Assuming this is for new light pole. Please provide the documentation for the existing pole or pictures so there is no mix up.

Answer: Poles to be salvaged and provided by others.

Question 3: Is contractor to provide camera provisions? If so please define what will be needed and how many cameras are anticipated per pole.

Answer: Cameras are to be installed by others.

Question 4: Regarding manpower: Is there a required amount of supervision specified? Do our supervisors need to have specific qualifications?

Answer: The only specific manpower requirement is to maintain the proper number of hard badged "escort" personnel. The minimum is 3 but there is no maximum

Question 5: Is there a specific vehicle inspection process that needs to be followed prior to each work day / site access?

Answer: All vehicles entering the site are always "subject" to search based on current security posture, however, vehicles drive by hard badged "escort" personnel are not typically searched. All other vehicles will be searched.

Question 6: Please clarify our PoP, shut downs between phases, etc. Do we have to demob after each phase?

Answer: Demobilization of any equipment on-site or stored material on-site would not be necessary.

Question 7: Note 1 on EP1/003 indicates that: "SECURITY CAMERA POWER ORIGINATES FROM AN EXISTING 225A, 480V, 3 PH, 3W PANELBOARD LOCATED BETWEEN EXISTING SECURITY CAMERAS POLE 13 AND 14 ALONG TAA PROPERTY LINE." If we are going to run this new power feeder can we get this location defined on the electrical print set?

Answer: See note 2 on revised sheet EP1.001

Question 8: What is the electrician's responsibility regarding this note from sheet EP1.002: "APPROXIMATE LOCATION OF RELOCATED ZONE SECURITY PANEL. FINAL LOCATION AND SOURCE PANEL TO BE DETERMIND." Is this the source panel for the new security cameras?

Answer: See note 2 on revised sheet EP1.001. The power panel is located in Existing Building 823.

MISCELLANEOUS

1. Updated Bid Schedule – Updated description of Items 12 and 13

**TUCSON INTERNATIONAL AIRPORT
DBB2 FENCING FOR ASE
UNIT PRICES**

ITEM NO.	SPEC. NO.	DESCRIPTION	UNIT	ESTIMATED QUANTITY	UNIT PRICE	BID AMOUNT
1	MC-001-9.1	Airport Safety and Security	LS	1		
2	SS-162-5.1	3-Strand Cable Vehicle Barrier (5-ft)	LF	5,750		
3	C-102-5.1	Temporary Erosion Control	LS	1		
4	C-105-6.1	Mobilization	LS	1		
5	F-162-5.1	Temporary Chain-Link Fence	LF	50		
6	F-162-5.2	Temporary Concrete Barrier	LF	2,040		
7	F-162-5.3	6-Strand Barbed Wire Chain-Link Fence (8-ft) with Buried Wildlife Barrier	LF	6,270		
8	F-162-5.4	Removal of 4-foot Wire Perimeter Fence	LF	330		
9	P-152-4.1	Unclassified Excavation	CY	870		
10	PAG-201-5.1	Clearing and Grubbing	ACRE	9.2		
11	PAG-303-5.1	Recycled Asphalt Millings Road (Owner Provided)	CY	1,290		
12	260501-4.1	Install Salvaged Light Fixture on Salvaged 25' Light Pole with New Concrete Base	EA	11		
13	260501-4.2	Install Salvaged 25' Camera Pole on New Concrete Base	EA	4		
14	260519-4.1	3-1/0 XHHW, #6 Ground	LF	1,850		
15	260519-4.2	2-3/0 XHHW, #6 Ground	LF	4,450		
16	260519-4.3	Splice Electrical Conduit and Conductors into Existing Lighting Electrical Circuits	EA	1		
17	260533-4.1	Install New No. 5 Electrical Pull Box	EA	11		
18	260533-4.2	Install New No. 3.5 Electrical Pull Box	EA	11		
19	260533-4.3	Install New Hubbell PG1324DA24H (or Equal) Pull Box For Fiber Optic Cable	EA	15		
20	260533-4.4	Multiple-way (2)-2" Conduit, Direct Buried	LF	4,390		
21	260533-4.5	Single-way (1)-2" Conduit, Direct Buried	LF	1,810		
22	260533-4.6	Single-way (1)-2" Conduit, Concrete Encased	LF	50		

2

Total Bid - Schedule 1

SECTION 26 05 01 - COMMON ELECTRICAL REQUIREMENTS**PART 1 - GENERAL****1.1 SUMMARY**

- A. Includes but Not Limited To:
 - 1. General electrical system requirements and procedures.
 - 2. Perform excavating and backfilling work required by work of this Division as described in Contract Documents.
 - 3. Make electrical connections to equipment provided under other Sections.
- B. Products Supplied but Not Installed Under This Section:
 - 1. Anchor bolts and templates for exterior lighting equipment bases.

1.2 SUBMITTALS

- A. Product Data:
 - 1. Provide following information for each item of equipment:
 - a. Catalog Sheets.
 - b. Assembly details or dimension drawings.
 - c. Installation instructions.
 - d. Manufacturer's name and catalog number.
 - e. Name of local supplier.
 - 2. Do not purchase equipment before approval of product data.
- B. Shop Drawings:
 - 1. Indicate precise equipment to be used, including all options specified. Indicate wording and format of nameplates where applicable. Submit in three-ring binder with hard cover.
- C. Quality Assurance / Control:
 - 1. Report of site tests, before Substantial Completion.
- D. Closeout:
 - 1. Operations And Maintenance Manual Data:
 - 1) Provide operating and maintenance instructions for each item of equipment submitted under Product Data.
 - 2) Include copy of approved shop drawings.
- E. Poles. The following shall be for Light and Camera Poles:
 - 1. Shop Drawings.
 - 1) Foundation details with structural calculations.
 - 2) Installation Details.
 - 3) Include dimensions, wind load determined in accordance with AASHTO LTS-5, pole deflection, pole class, and other applicable information conforming to IESNA HB-9.
 - 4) Include seismic design data and calculations for International Building Code (IBC) and all local regulations.
 - 5) Pole locations are + or – 5 feet. Pole height shall be as shown on plans (25 feet).
 - 2. Product Data: Submit dimensions, ratings, and performance data.
 - 1) Brackets
 - 2) Anchorage Systems.

- 3. Manufacturer's Instructions.
 - 1) Foundation requirements
 - 2) Mounting and wiring details
 - 3) Submit instructions prior to installation.

1.3 QUALITY ASSURANCE

- A. Requirements of Regulatory Agencies:
 - 1. NEC and local ordinances and regulations shall govern unless more stringent requirements are specified.
 - 2. Material and equipment provided shall meet standards of NEMA or UL, or ULC, CSA, or EEMAC and bear their label wherever standards have been established and label service is available.

1.4 OWNER'S INSTRUCTIONS

- A. Provide competent instructor for three days to train maintenance personnel in operation and maintenance of electrical equipment and systems. Factory representatives shall assist this instruction as necessary. Schedule instruction period at time of final inspection.

PART 2 - PRODUCTS

2.1 Related Sections: **Section 26 56 13 Lighting Poles and Standards**

PART 3 - EXECUTION

3.1 EXAMINATION

- A. Confirm dimensions, ratings, and specifications of equipment to be installed and coordinate these with site dimensions and with other Sections.

3.2 INSTALLATION

- A. General:
 - 1. Locations of electrical equipment shown on Drawings are approximate only. Field verify actual locations for proper installation.
 - 2. Coordinate electrical equipment locations and conduit runs with those providing equipment to be served before installation or rough-in.
 - 3. Work related to other trades which is required under this Division, such as cutting and patching, trenching, and backfilling, shall be performed according to standards specified in applicable Sections.

3.3 FIELD QUALITY CONTROL

- A. Site Tests: Test systems and demonstrate equipment as working and operating properly. Notify Engineer before test. Rectify defects at no additional cost to Owner.

PART 4 – METHOD OF MEASUREMENT

4.1 INSTALL SALVAGED LIGHT FIXTURE ON SALVAGED 25 FOOT LIGHT POLE WITH NEW CONCRETE BASE. Installation of salvaged light pole assemblies to include the following: salvaged light poles,

11/13/20

salvaged light fixture assemblies including mounting brackets, new concrete foundation with structurally engineered calculations, 1" conduits and UFER (concrete encased grounding electrode) per each complete in accordance with the Plans and Specifications and as accepted.

4.2 INSTALL SALVAGED 25' CAMERA POLE ON NEW CONCRETE BASE. Installation of salvaged camera pole assemblies to include the following: salvaged poles, unistrut mounting for future IT box, new concrete foundation with structurally engineered calculations, 2" conduits and UFER (concrete encased grounding electrode) per each complete in accordance with the Plans and Specifications and as accepted.

PART 5 - BASIS OF PAYMENT

5.1 ELECTRICAL SERVICES. Payment will be made at the contract price for the electrical services completed and accepted. This price shall be full compensation for furnishing all materials and for all labor, equipment, tools, and incidentals necessary to complete these items. The unit price of each of these items shall also include the Contractor's overhead, profit and markup.

Payment will be made under:

Item 260501-4.1 Install Salvaged Light Fixture on Salvaged 25' Light Pole with New Concrete Base – per Each

Item 260501-4.2 Install Salvaged 25' Camera Pole on New Concrete Base – per Each

END OF SECTION

PAGE INTENTIONALLY LEFT BLANK

SHEET INDEX		
Sheet	Sheet Reference Number	Sheet Title
GENERAL		
1	G10.001	COVER SHEET
2	G10.002	INDEX OF SHEETS & SUMMARY OF QUANTITIES
GENERAL NOTES		
3	G10.003	GENERAL NOTES
4	G10.004	SAFETY AND SECURITY NOTES
PROJECT SITE PLAN		
5	G14.001	PROJECT SITE PLAN
6	G14.002	SURVEY CONTROL PLAN
7	G14.003	CONTRACTOR HAUL ROUTE PLAN
8	G14.004	CONTRACTOR HAUL ROUTE PLAN - STAGE IV
9	G15.001	CONSTRUCTION SAFETY AND PHASING PLAN I
10	G15.002	CONSTRUCTION SAFETY AND PHASING PLAN II
11	G15.003	CONSTRUCTION SAFETY AND PHASING PLAN III
12	G15.004	CONSTRUCTION SAFETY AND PHASING DETAILS
CIVIL		
13	VF1.001	EXISTING CONDITIONS I
14	VF1.002	EXISTING CONDITIONS II
15	VF1.003	EXISTING CONDITIONS III
16	VF1.004	EXISTING CONDITIONS IV
17	CD1.001	CIVIL DEMOLITION PLAN I
18	CD1.002	CIVIL DEMOLITION PLAN II
19	CD1.003	CIVIL DEMOLITION PLAN III
20	CD1.004	CIVIL DEMOLITION PLAN IV
21	CF1.001	FENCING PLAN I
22	CF1.002	FENCING PLAN II
23	CF1.003	FENCING PLAN III
24	CF1.004	FENCING PLAN IV
25	CF5.001	FENCING DETAILS I
26	CF5.002	FENCING DETAILS II
27	CF5.003	FENCING DETAILS III
28	CF5.004	MISCELLANEOUS DETAILS
ELECTRICAL		
29	ED0.001	ELECTRICAL LEGEND AND NOTES
30	EP1.001	ELECTRICAL INSTALLATION PLAN I
31	EP1.002	ELECTRICAL INSTALLATION PLAN II
32	EP1.003	ELECTRICAL INSTALLATION PLAN III
33	EP1.004	ELECTRICAL INSTALLATION PLAN IV
34	EP5.001	CAMERA POLE BASE DETAIL
35	EP5.002	CONDUIT DUCTBANK DETAILS
36	EP5.003	LIGHTING POLE BASE DETAILS

ITEM NO.	SPEC. NO.	DESCRIPTION	UNIT	ESTIMATED QUANTITY
1	MC-001-9.1	Airport Safety and Security	LS	1
2	SS-162-5.1	3-Strand Cable Vehicle Barrier (5-ft)	LF	5,750
3	C-102-5.1	Temporary Erosion Control	LS	1
4	C-105-6.1	Mobilization	LS	1
5	F-162-5.1	Temporary Chain-Link Fence	LF	50
6	F-162-5.2	Temporary Concrete Barrier	LF	2,040
7	F-162-5.3	6-Strand Barbed Wire Chain-Link Fence (8-ft) with Buried Wildlife Barrier	LF	6,270
8	F-162-5.4	Removal of 4-foot Wire Perimeter Fence	LF	330
9	P-152-4.1	Unclassified Excavation	CY	870
10	PAG-201-5.1	Clearing and Grubbing	ACRE	9.2
11	PAG-303-5.1	Recycled Asphalt Millings Road (Owner Provided)	CY	1,290
12	260501-4.1	Install Salvaged Light Fixture on Salvaged 25' Light Pole with New Concrete Base	EA	11
13	260501-4.2	Install Salvaged 25' Camera Pole on New Concrete Base	EA	4
14	260519-4.1	3-1/0 XHHW, #6 Ground	LF	1,850
15	260519-4.2	2-3/0 XHHW, #6 Ground	LF	4,450
16	260519-4.3	Splice Electrical Conduit and Conductors into Existing Lighting Electrical Circuits	EA	1
17	260533-4.1	Install New No. 5 Electrical Pull Box	EA	11
18	260533-4.2	Install New No. 3.5 Electrical Pull Box	EA	11
19	260533-4.3	Install New Hubbell PG1324DA24H (or Equal) Pull Box For Fiber Optic Cable	EA	15
20	260533-4.4	Multiple-way (2)-2" Conduit, Direct Buried	LF	4,390
21	260533-4.5	Single-way (1)-2" Conduit, Direct Buried	LF	1,810
22	260533-4.6	Single-way (1)-2" Conduit, Concrete Encased	LF	50

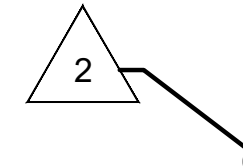

PLANS PREPARED BY:



Digitally Signed 04/01/2026

ISSUED FOR BID	ADDENDUM 1	ADDENDUM 2	NO.	REVISIONS / SUBMISSIONS	DATE
IFB					



DESIGNED BY: DAG
 DRAWN BY: DAG
 CHECKED BY: JEF
 DATE: 2/06/2026
 SCALE: AS SHOWN
 TAA PROJ# 10119102

SHEET OVERVIEW TITLE
INDEX OF SHEETS & SUMMARY OF QUANTITIES

SHEET REFERENCE NUMBER:
G10.002
 SHEET 2 OF 36

Last Saved by: AThompson on: Mar 30, 2026 2:06 PM File: L:\2024\A12-24000999 - TUS ASE Program DBB 2 - Security Fence\Drawings\DBB - Security Fence (OLD CMAR)\10119102\DBB2-EP1.001 TO 004.dwg

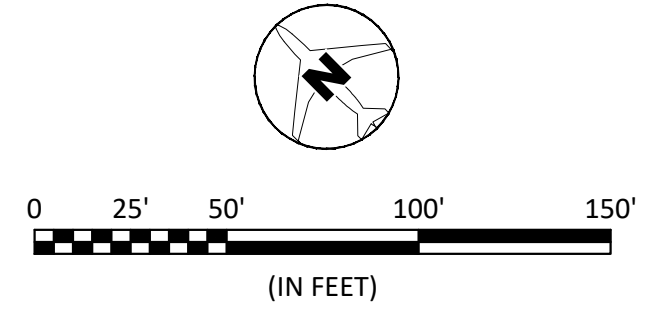

LEGEND

- COM ——— EXISTING COMMUNICATION LINE
- EL ——— EXISTING UNDERGROUND ELECTRICAL LINES
- OEL ——— EXISTING OVERHEAD ELECTRICAL LINES
- EL ——— PROPOSED UNDERGROUND ELECTRICAL LINE
- COM ——— PROPOSED UNDERGROUND COMMUNICATION LINE
- CONDUIT SPLICE POINT
- E EXISTING ELECTRICAL PULLBOX
- E EXISTING ELECTRICAL JUNCTION BOX
- C EXISTING COMMUNICATIONS STRUCTURE
- LP EXISTING LIGHT ON 25' POLE
- PB NEW ELECTRICAL PULL BOX
- EXISTING LIGHT FIXTURE ON NEW 25' POLE
- NEW 25' CAMERA POLE WITH NEW CONCRETE BASE
- C NEW COMMUNICATIONS PULLBOX

NOTES:

1. SALVAGED LIGHT FIXTURES ARE RATED AT 480V, 1PH, 2 WIRE. LIGHTING CIRCUIT ORIGINATES FROM PANEL "P-2" IN BUILDING 823.
2. THE EXISTING IFA MAGAZINE "A" PERIMETER SECURITY FENCE AND ASSOCIATE POLE MOUNTED LED AREA LIGHTING IS SERVED FROM THE EXISTING BUILDING 823 (BLDG. 823 IS A VERY SMALL UTILITY/STORAGE BUILDING LOCATED JUST SOUTH OF BUILDING 870), AND PANEL "P-2" RATED AT 480V, 3 PHASE, 4 WIRE, 225A RATED BUS, 30 CIRCUIT PANEL LOCATED WITHIN BLDG. 823. THE SECURITY FENCE AREA POLE LIGHTING IS SERVED FROM AN UNDERGROUND 480V, 3 PHASE, 3 WIRE BRANCH CIRCUIT ROUTED ALONG THE ENTIRE FENCE INTERIOR PERIMETER. EACH FENCE POLE AND LED FIXTURE IS SERVED BY A DEDICATED UNDERGROUND (UG) PULL BOX AND TAPS THE 3 PHASE BRANCH CIRCUIT ACROSS PHASE-TO-PHASE AT 480V, SINGLE PHASE, 2 WIRE PLUS EQUIPMENT GROUND CONDUCTOR. EACH POLE HAS AN EXTERNAL NEMA 3R JUNCTION BOX MOUNTED AT 18 INCHES ABOVE FINISHED GRADE (AFG) AT THE BASE OF POLE WITH 480V, SINGLE PHASE SPLICE USING TWO (2) IN-LINE FUSES TO SERVE THE POLE MOUNTED AREA LED FIXTURE. THE UNDERGROUND 480V, 3 PHASE, 3 WIRE BRANCH CIRCUIT CONDUCTORS ARE ASSUMED TO BE 3-#1/0 AWG, #6 GND. TAP CONDUCTOR SIZE AT EACH POLE FROM PULL BOX TO JUNCTION BOX ARE 2-#8 AWG, #10 GND, 1" C. THE LED POLE MOUNTED FIXTURE TO BE SALVAGED AND REINSTALLED ON THE NEW POLES HAVE A TYPE V (LIGHT DISTRIBUTION PATTERN, AND ARE RATED AT 480V, SINGLE PHASE, 2 WIRE.

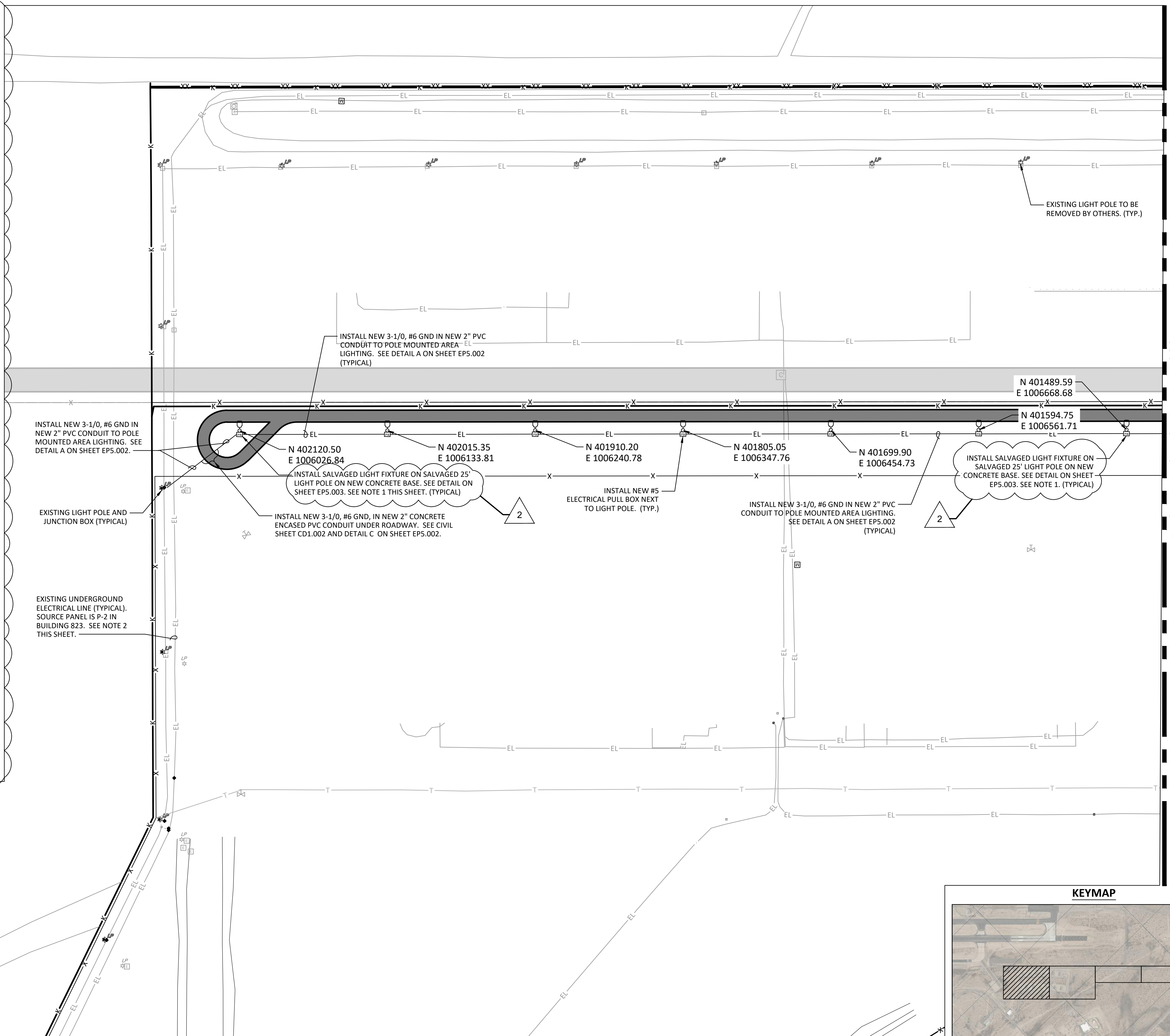

MATCHLINE, SEE SHEET EP1.002

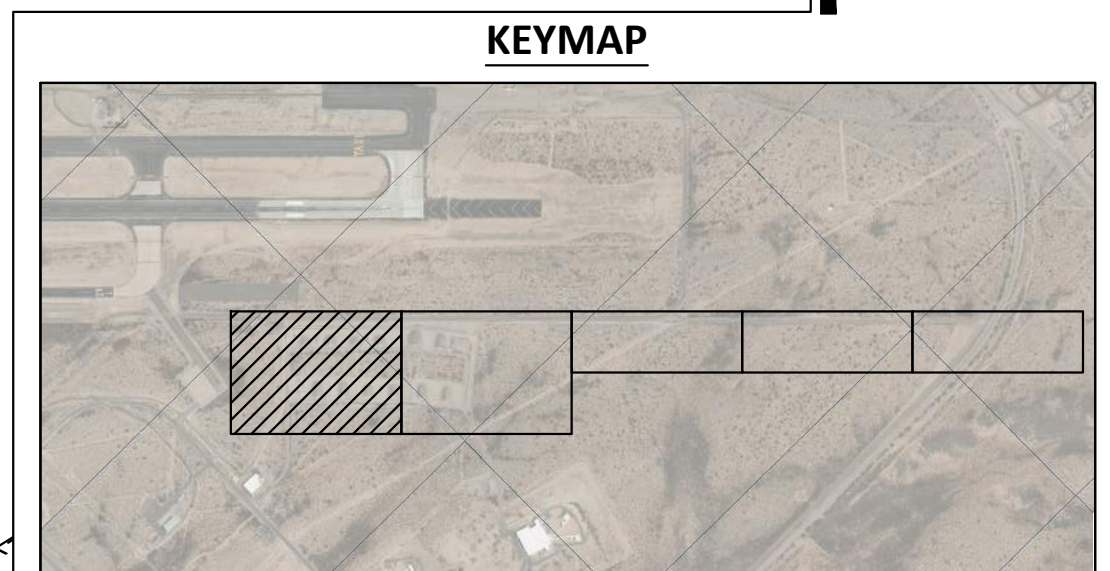

PLANS PREPARED BY:



NO.	REVISIONS / SUBMISSIONS	DATE
1	ISSUED FOR BID	2/06/2026
2	ADDENDUM 2	4/01/2026

TUCSON
 AIRPORT AUTHORITY
 SECURITY FENCING FOR ASE DBB2

DESIGNED BY: DAG
 DRAWN BY: DAG
 CHECKED BY: JEF
 DATE: 2/06/2026
 SCALE: AS SHOWN
 TAA PROJ# 10119102

SHEET OVERVIEW TITLE
**ELECTRICAL INSTALLATION
 PLAN I**

SHEET REFERENCE NUMBER:
EP1.001
 SHEET 30 OF 36

Last Saved by: AThompson on: Mar 30, 2026 1:46 PM File: L:\2024\A12-24000999 - TUS ASE Program DBB 2 - Security Fence\Drawings\DBB - Security Fence\010119102\DBB2-EP1.001 TO 004.dwg

MATCHLINES, SEE SHEET EP1.002

MATCHLINE THIS SHEET

MATCHLINE THIS SHEET

MATCHLINE, SEE SHEET EP1.004

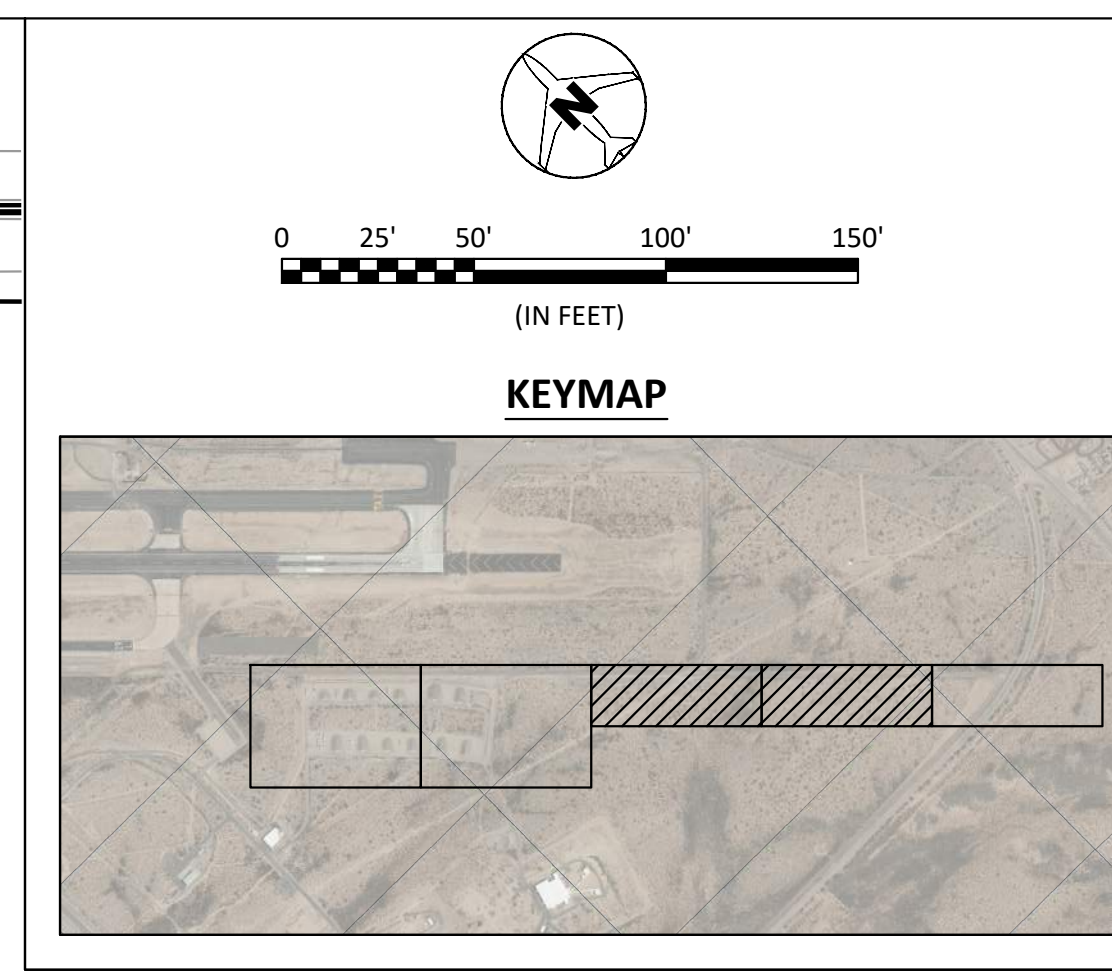
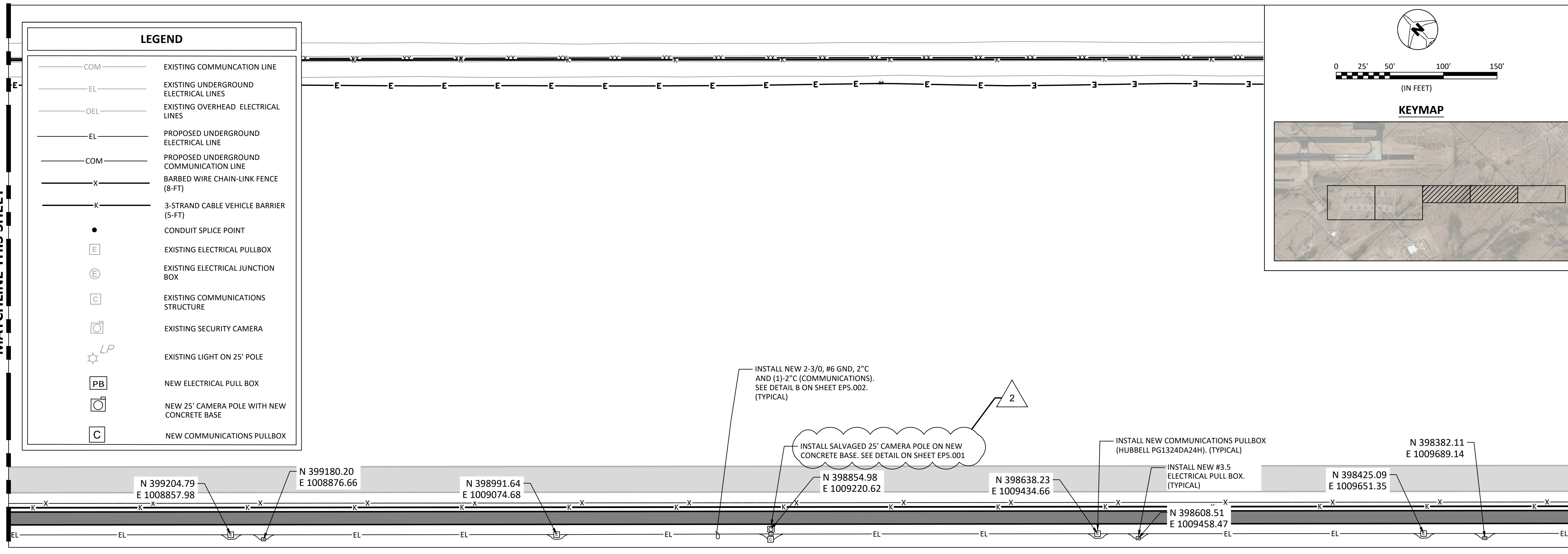
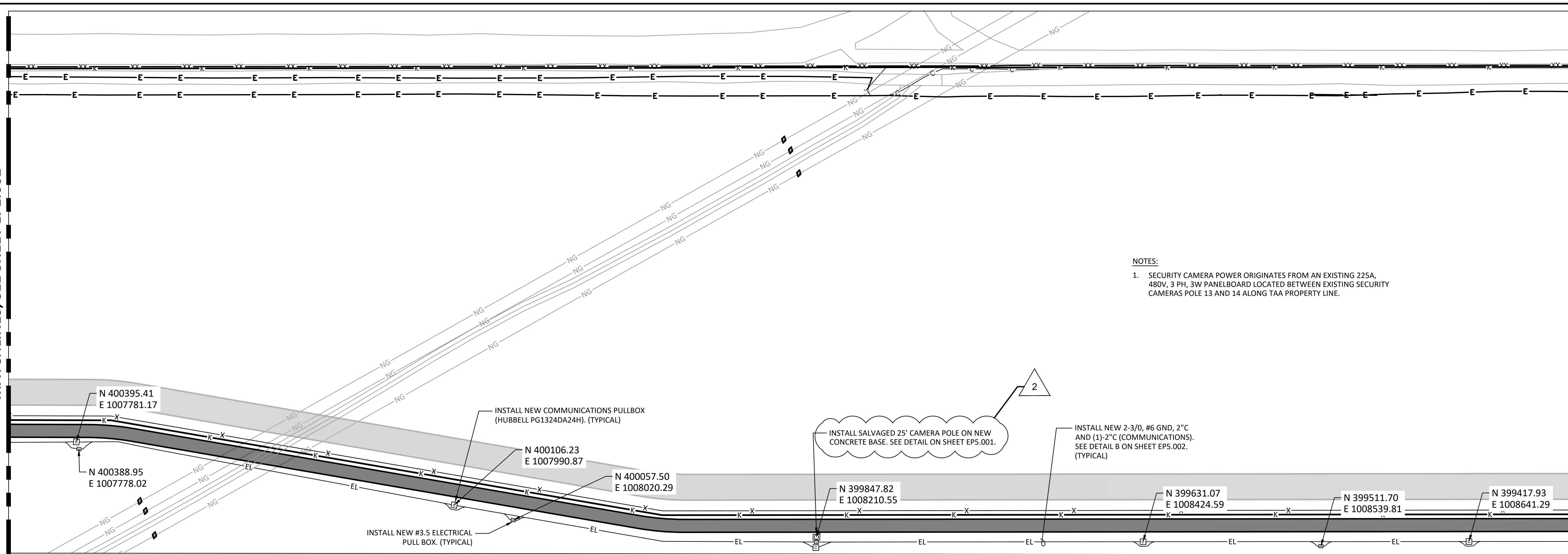

PLANS PREPARED BY:

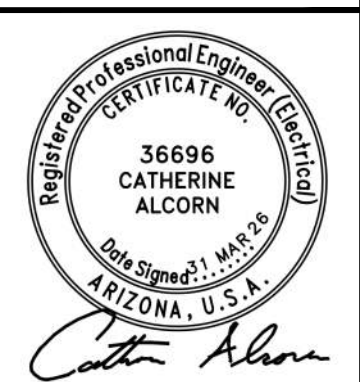

NO.	REVISIONS / SUBMISSIONS	DATE
1	ISSUED FOR BID	2/06/2026
2	ADDENDUM 2	4/01/2026

TUCSON
AIRPORT AUTHORITY
SECURITY FENCING FOR ASE DBB2

DESIGNED BY: KP	CHECKED BY: ODS
DRAWN BY: KP	DATE: 2/06/2026
SCALE: AS SHOWN	TAA PROJ# 10119102

SHEET OVERVIEW TITLE
ELECTRICAL INSTALLATION PLAN III

SHEET REFERENCE NUMBER:
EP1.003
SHEET 32 OF 36

